

Farringdon Village Hall News No. 3

August 2021

In Newsletter no. 2 we provided a summary of the results from the Village Questionnaire. This formed the basis of the briefing we have given to the Architects who are in the throws of collating all the ideas and putting them into a coherent concept plan.

These concepts will be discussed by the FVH Trustees to make sure that all the required facilities have been included, iron out any wrinkles and make sure any new ideas are considered and included if appropriate. The sketch below shows our current thinking for the location of the Village Hall at the West end of the site.

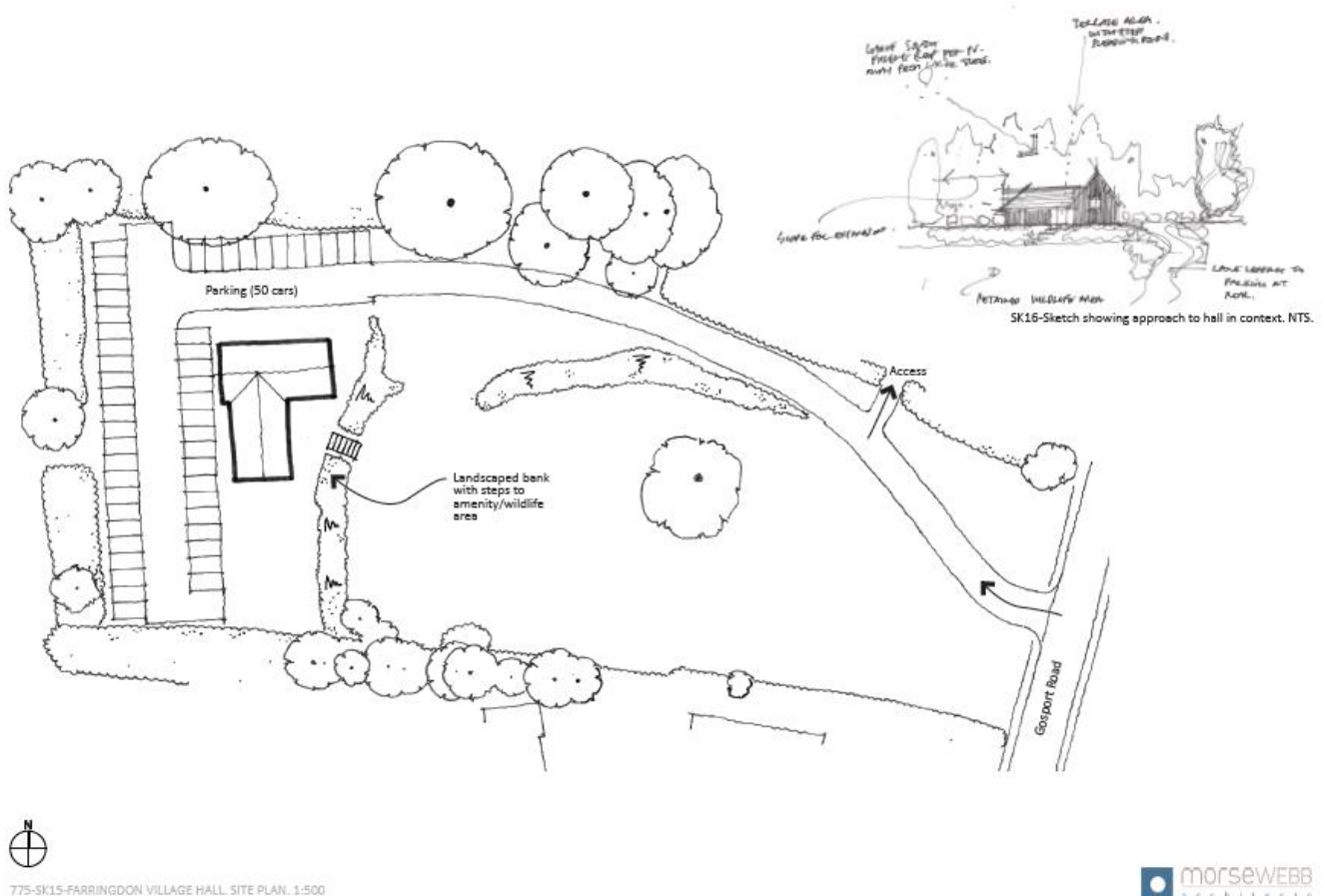

We believe this layout has advantages because (in no particular order):

- Keeps village hall activities remote from houses on A32;
- Located on area that has recently been disturbed;
- Maximises ecological area;
- Makes a feature of the Chestnut tree with TPO;
- Provides a panoramic vista of Lower & Upper Farringdon;
- Risk of car parking interfering with adjacent housing access is minimised;
- It will be relatively easy to make the site secure from trespass.

The Trustees would like to make the Village Hall as “green” as possible within the constraints of our budget. A couple of details; we intend that the Village Hall has its own solar panels generating electricity and the car park has rain absorbent grass pavers.

More news will be issued as the project progresses. In the meantime, comments, ideas and suggestions can be made through the portal on the FVH website..